

**NOTE: Order parts by Catalog Number only
DO NOT order by Reference Number**

For information on Cutters, Die Heads and Reamers SEE INDEX

Ref. No.	Catalog No.	Description	Ref. No.	Catalog No.	Description
1	46790	E-900 Screw, 12-24 x 1/4" (6)	28	45245	E-3124 Drive Cap (3)
2	40270	E-1741 Lock Washer (6)	29	89150	C-1204 Hand Wheel
3	43735	D-334 Centering Head	30	43540	C-701 Scroll
	19346	Centering Head (Europe)	31	43525	C-698 Cap
4	46500	E-631 Rear Jaw (3)	32	45295	E-3175 Screw 1/4" - 18 x 2 1/4" (6)
5†	45260	E-3127 Step Pin (3)	33	44090	D-638-X Chuck Jaw Set
6	44095	D-841 Scroll	34	44715	E-1666-X Jaw Insert Set
7	43740	D-335 Back Plate		97365	E-10794 Jaw Insert Set F/Coated Pipe
	19356	Back Plate (Europe)	35	45825	E-4439 Strain Relief Plate
8	44100	D-842 Drive Shaft	36	44735	E-1700 Screw 1/4"-20 x 1/4" (2)
9	42845	A-27-X Body Assembly (Incl. Ref. No. 10, 11, 12, 13, 14, 17, 18, 35, 36, 49, 50, 51, 52, 53)	37	44525	E-1484 Spring Ring (2)
10	45335	E-3240-R Rear Bearing-Bronze	38	45280	E-3144 Screw #8-32 x 1/8" (2)
11	45270	E-3129-X Front Bearing-Bronze	39	44425	E-1334-X Support Bar (Incl. Ref. No. 37)
12	46860	E-912 Grease Fitting	40	44725	E-1697-X Ring Assembly (2) (Incl. Ref. No. 41, 42)
13†	45310	E-3205 Dowel Pin	41	46050	E-4596 Set Screw 1/4" - 18 x 1/4" (2)
14	85920	E-10006 Pop Rivet (10)	42	44720	E-1692 Snap Ring (2)
15		E-3203 Name Plate	43*	87740	3177 Motor (115V) Std. 38 RPM
16	46035	E-4548 Screw 1/4" - 18 x 1 1/4"		87780	3277 Motor (230V) Std. 38 RPM
17†	45345	Thrust Ring	44	46745	E-891 Screw 3/8" - 16 x 1 1/4" (2)
18	33785	E-751 Set Screw 1/4" - 24 x 1/4" (2)	45	44165	D-970 Rear Centering Assy.
19	44085	D-782 Pressure Ring	46	30027	Drive Ring, Type II
20	45265	E-3128 Screw 1/4" - 24 x 1/4" (3)	47	30022	Drive Pin, Type II (3)
21	45300	E-3177 Screw 1/4" - 24 x 1/4" (3)	48	30017	Ring Gear, Type II
22	43530	C-699 Ring Gear	49	46670	Hex Bolt 3/4" - 16 x 2 (4)
23	45255	E-3126 Pressure Plunger (3)	50	44230	Washer 1/4" (4)
24	45285	E-3158 Pressure Spring (3)	51	40930	Lock Washer 1/4" (4)
25	45225	E-3053 Pressure Plug (3)	52	45385	Wing Nut 3/4" - 16 (4)
26	45250	E-3125 Drive Wedge (3)	53	88690	Warning Plate
27	44310	E-1162 Drive Spring (3)	54	46735	Cord Grommet
			—	41615	Grease for ring gear, 4 oz. tube

*Refer to Motor Model No. for Component Parts

Service Notes:

†Ref. 5 Step Pins are easily removed by pushing from inside to outside.

†Ref. 13 Before removing front bearing sleeve (Ref. No. 11), dowel pin and grease fitting must be pushed out from inside.

†Ref. 17 Position thrust ring so that offset screw holes are closer to chuck

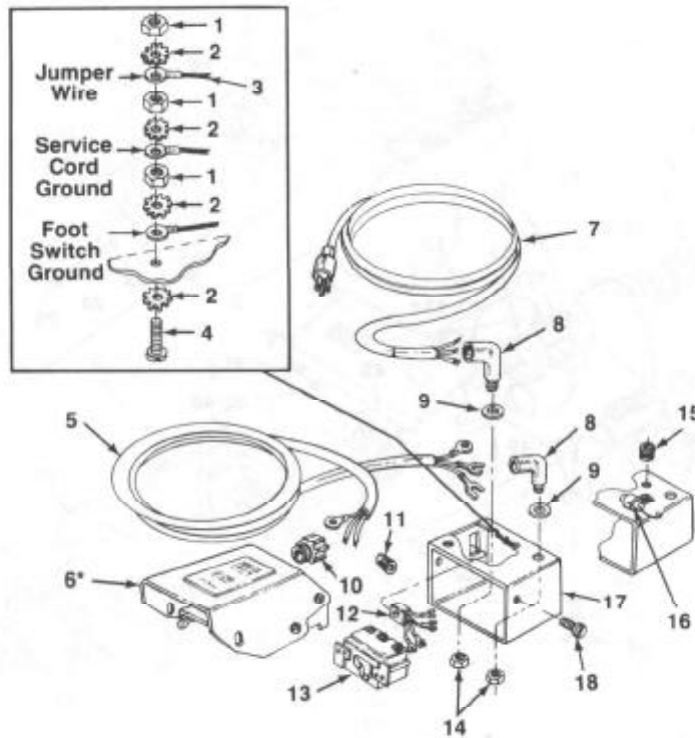

Ref. No.	Catalog No.	Description
1	44695	E-1663 Hex Nut #10-24 (3)
2	46985	E-945 Ext Tooth Washer #10 (4)
3	85925	E-3359 Jumper Wire
4	92455	E-10412 Screw #10-24 x 3/4
5	36707	Foot Switch Cord
6*	36642	B-294 Foot Switch (Incls. Ref. 5 & 10)
7	46740	E-890-2 Power Cord w/Plug (115V)
	46410	E-607 Power Cord w/Plug (230V)
8	46900	E-923 Connector 90° (2)
9	68870	E-1482 Washer
10	36732	Cord Connector
11	44635	E-1517 Wire Nut (2)
12	86675	E-3190-X Wire Harness
13	44505	E-1417 Switch
14	68865	E-1475 Bushing (2)
15	45805	E-4435 Snap Bushing
16	46320	E-5526-X Suppressor Kit (230V Only)
17	87860	C-549 Switch Box
18	44180	E-1017 Screw 8-32 x 1/16 (2)

*See Footswitch Model No. for Component Parts